

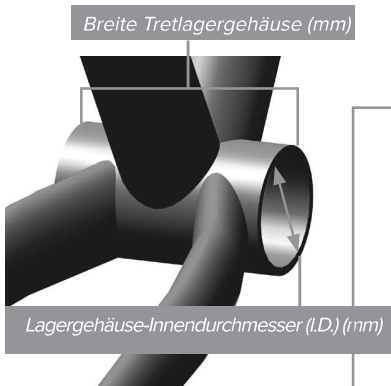

# DUB: MTB TRETLAGER AUSWÄHLEN

Die Tabelle zeigt, welches Tretlager zu Ihrem Rahmen passt.



| Breite Tretlagergehäuse (mm) | Lagergehäuse-Innendurchmesser (mm) | Kurbelgarnitur | Innenlager Bezeichnung                     | Teilenummer                                 |
|------------------------------|------------------------------------|----------------|--|---|
| 73                           | 42                                 | MTB            | DUB BB30 73 MTB<br>DUB Ceramic BB30 73 MTB | 00.6418.017.000<br>Ceramic: 00.6418.017.005 |
|                              |                                    | MTB Wide       | DUB BB30 73 MTB Wide                       | 00.6418.017.004                             |
|                              | 46                                 | MTB            | DUB PF30 73 MTB<br>DUB Ceramic PF30 73 MTB | 00.6418.018.000<br>Ceramic: 00.6418.018.007 |
|                              |                                    | MTB Wide       | DUB PF30 73 MTB Wide                       | 00.6418.018.006                             |
| 83                           | 42                                 | MTB Ai         | ■ DUB BB30 83 MTB Ai                       | 00.6418.027.002                             |
|                              | 46                                 | MTB Ai         | ■ DUB PF30 83 MTB Ai                       | 00.6418.028.003                             |
| 89.5                         | 41                                 | MTB            | DUB PF 89.5 MTB<br>DUB Ceramic PF 89.5 MTB | 00.6418.016.000<br>Ceramic: 00.6418.016.006 |
|                              |                                    | MTB Wide       | DUB PF 89.5 MTB Wide                       | 00.6418.016.005                             |
| 92                           | 41                                 | MTB            | DUB PF 92 MTB<br>DUB Ceramic PF 92 MTB     | 00.6418.016.000<br>Ceramic: 00.6418.016.006 |
|                              |                                    | MTB Wide       | DUB PF 92 MTB Wide                         | 00.6418.016.005                             |
|                              |                                    | Super Boost +  | DUB PF 92 SB+                              | 00.6418.020.000                             |
| 100                          | 46                                 | FAT            | DUB PF30 100 FAT                           | 00.6418.028.004                             |
| 104.5                        | 41                                 | DH             | DUB PF 104.5 DH                            | 00.6418.016.002                             |
| 107                          | 41                                 | DH             | DUB PF 107 DH                              | 00.6418.016.003                             |
| 121                          | 41                                 | FAT            | DUB PF 121 FAT                             | 00.6418.016.001                             |

Ist das Lagergehäuse mit einem Gewinde versehen?

Nein

Ja

|                     |                         |               |  |   |
|---------------------|-------------------------|---------------|--|---|
| 68                  | Englisches Gewinde/ BSA | MTB           | DUB BSA 68 MTB<br>DUB Ceramic BSA 68 MTB | 00.6418.015.000<br>Ceramic: 00.6418.015.008 |
|                     |                         | MTB Wide      | DUB BSA 68 MTB Wide                      | 00.6418.015.005                             |
| 73                  | Englisches Gewinde/ BSA | MTB           | DUB BSA 73 MTB<br>DUB Ceramic BSA 73 MTB | 00.6418.015.000<br>Ceramic: 00.6418.015.008 |
|                     |                         | MTB Wide      | DUB BSA 73 MTB Wide                      | 00.6418.015.005                             |
|                     |                         | Super Boost + | DUB BSA 73 SB+                           | 00.6418.019.000                             |
| 73 with Chain Guide | Englisches Gewinde/ BSA | MTB Ai        | ■ DUB BSA 73 MTB Ai                      | 00.6418.031.001                             |
|                     |                         | MTB           | DUB BSA 73 Guide MTB                     | 00.6418.015.000<br>Ceramic: 00.6418.015.008 |
|                     |                         | MTB Wide      | DUB BSA 73 Guide MTB Wide                | 00.6418.015.005                             |
| 83                  | Englisches Gewinde/ BSA | Super Boost + | DUB BSA 73 Guide SB+                     | 00.6418.021.000                             |
|                     |                         | DH            | DUB BSA 83 DH                            | 00.6418.015.002                             |
| 100                 | Englisches Gewinde/ BSA | MTB Ai        | ■ DUB BSA 83 MTB Ai                      | 00.6418.031.000                             |
|                     |                         | FAT           | DUB BSA 100 FAT                          | 00.6418.015.001                             |

■ nur Cannondale®

# INNENLAGER-DISTANZSTÜCKE FÜR DUB™-KURBELGARNITUR

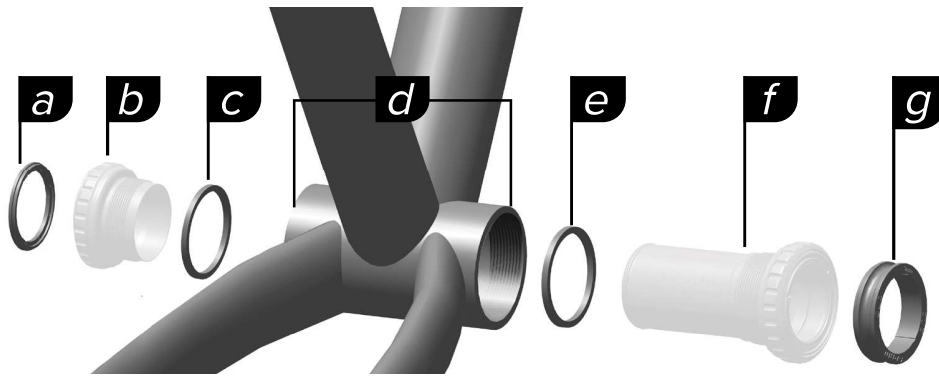

- a. Distanzstück, Nicht-Antriebsseite, außen links
- b. Linke Lagerschale
- c. Distanzstück, Nicht-Antriebsseite, innen links
- d. Breite Tretlagergehäuse
- e. Distanzstück, Antriebsseite, innen rechts
- f. Rechte Lagerschale und Innenlagerhülse
- g. Distanzstück, Antriebsseite, außen rechts

| Ausführung und Breite Tretlagergehäuse (mm) |                     | Kurbelgarnitur | Distanzstück, außen links (mm) | Distanzstück, innen links (mm) | Distanzstück, innen rechts (mm) | Distanzstück, außen rechts (mm) |
|---|---------------------|----------------|--------------------------------|--------------------------------|---------------------------------|---------------------------------|
| BSA   | 68                  | MTB            | -                              | 2.5                            | 2.5                             | 4.5                             |
|   |                     | MTB Wide       | 3                              | 2.5                            | 2.5                             | 7.5                             |
|   | 73                  | MTB            | -                              | -                              | -                               | 4.5                             |
|   |                     | MTB Wide       | 3                              | -                              | -                               | 7.5                             |
|   |                     | Super Boost +  | 4.5                            | -                              | -                               | 9                               |
|   | 73 Ai               | MTB Ai         | 2.5                            | 2.5                            | -                               | 10.5                            |
|   | 73 with Chain Guide | MTB            | -                              | -                              | Kettenführung                   | 2                               |
|   |                     | MTB Wide       | 3                              | -                              | Kettenführung                   | 5                               |
|   |                     | Super Boost +  | 4.5                            | -                              | Kettenführung                   | 6.5                             |
|   | 83                  | DH             | -                              | 2.5                            | 2.5                             | 4.5                             |
|   | 83 Ai               | MTB Ai         | -                              | -                              | -                               | 5.5                             |
|   | 100                 | Fat            | 2                              | 2.5                            | 2.5                             | 6                               |
| PressFit                                    | 89.5                | MTB            | -                              | -                              | -                               | 4.5                             |
|   |                     | MTB Wide       | 3                              | -                              | -                               | 7.5                             |
|   | 92                  | MTB            | -                              | -                              | -                               | 2                               |
|   |                     | Super Boost +  | 4.5                            | -                              | -                               | 6.5                             |
|   |                     | MTB Wide       | 3                              | -                              | -                               | 5                               |
|   | 104.5               | DH             | -                              | -                              | -                               | 4.5                             |
|   | 107                 | DH             | -                              | -                              | -                               | 2                               |
|   | 121                 | Fat            | 2                              | -                              | -                               | 6                               |
| PressFit 30                                 | 73                  | MTB            | -                              | -                              | -                               | 4.5                             |
|   |                     | MTB Wide       | 3                              | -                              | -                               | 7.5                             |
|   | 83                  | DH             | 3                              | -                              | -                               | 6.5                             |
|   | 83 Ai               | MTB Ai         | -                              | -                              | -                               | 5.5                             |
|   | 100                 | Fat            | 4.5                            | -                              | -                               | 8.5                             |
| BB30  | 73                  | MTB            | -                              | -                              | -                               | 4.5                             |
|   |                     | MTB Wide       | 3                              | -                              | -                               | 7.5                             |
|   | 83 Ai               | MTB Ai         | -                              | -                              | -                               | 5.5                             |